

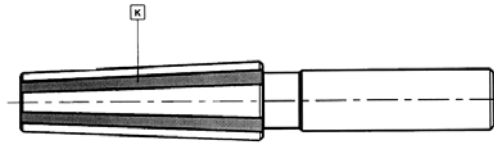

LIMPIADORES

LIMPIADOR PARA CONO MORSE



Ref.	Código	K
2108400	02001010103	M2
2108401	02001010104	M3
2108402	02001010105	M4
2108403	02001010106	M5

LIMPIADOR PARA CONO ISO

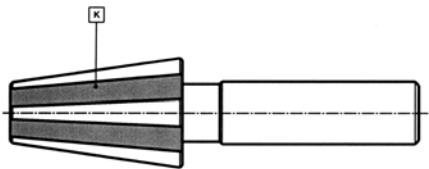

Ref.	Código	K
2108500	02005010101	30
2108501	02005010102	40
2108502	02005010103	45
2108503	02005010104	50

LIMPIADOR PARA CONO HSK

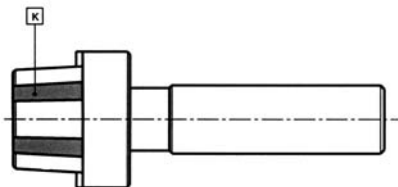

Ref.	Código	Forma A,C,E	Forma B,D,F
2108600	02014010100	HSK-25	HSK-32
2108601	02014010101	HSK-32	HSK-40
2108602	02014010102	HSK-40	HSK-50
2108603	02014010103	HSK-50	HSK-63
2108604	02014010104	HSK-63	HSK-80
2108605	02014010105	HSK-80	HSK-100
2108606	02014010106	HSK-100	HSK-125
2108607	02014010107	HSK-125	HSK-160

PORTAFRESAS DIN 69893 - HSK - A

PORTAFRESAS DE AMARRE POR CONTRACCIÓN TÉRMICA SERIE NORMAL

DIN 69882-8

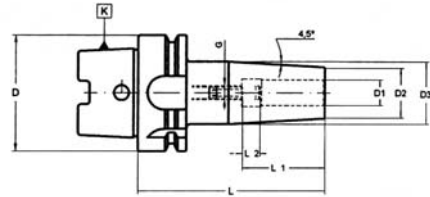

Desviación circular entre K y D1 ≤ 0,002

Ref.	Código	D HSK-A	D ₁	D ₂	D ₃	L	L ₁	L ₂	G
2108700	01214122203	40	3	12	20	120	20	5	M-5
2108701	01214122204	40	4	14	22	120	20	5	M-5
2108702	01214122205	40	5	16	22	120	25	5	M-5
2108703	01214121206	40	6	21	27	80	36	10	M-5
2108704	01214122206	40	6	21	27	120	36	10	M-5
2108705	01214121208	40	8	21	27	80	36	10	M-6
2108706	01214122208	40	8	21	27	120	36	10	M-6
2108707	01214121210	40	10	24	32	85	42	10	M-8
2108708	01214122210	40	10	24	32	120	42	10	M-8
2108709	01214121212	40	12	24	32	90	47	10	M-10
2108710	01214122212	40	12	24	32	120	47	10	M-10
2108711	01214121214	40	14	27	34	90	47	10	M-10
2108712	01214121216	40	16	27	34	90	50	10	M-12
2108713	01214122303	50	3	12	20	120	20	5	M-5
2108714	01214122304	50	4	14	22	120	20	5	M-5
2108715	01214122305	50	5	16	22	120	25	5	M-5
2108716	01214121306	50	6	21	27	85	36	10	M-5
2108717	01214122306	50	6	21	27	120	36	10	M-5
2108718	01214121308	50	8	21	27	85	36	10	M-6
2108719	01214122308	50	8	21	27	120	36	10	M-6
2108720	01214121310	50	10	24	32	90	42	10	M-8
2108721	01214122310	50	10	24	32	120	42	10	M-8
2108722	01214121312	50	12	24	32	90	47	10	M-10
2108723	01214122312	50	12	24	32	120	47	10	M-10
2108724	01214121314	50	14	27	34	90	47	10	M-10
2108725	01214121316	50	16	27	34	95	50	10	M-12
2108726	01214121318	50	18	33	42	95	50	10	M-12
2108727	01214121320	50	20	33	42	100	52	10	M-16
2108728	01214121403	63	12	20	20	85	20	5	M-5
2108729	01214122403	63	12	20	20	120	20	5	M-5
2108730	01214121404	63	14	22	22	85	20	5	M-5
2108731	01214122404	63	14	22	22	120	20	5	M-5
2108732	01214121405	63	16	22	22	85	25	5	M-5
2108733	01214122405	63	16	22	22	120	25	5	M-5
2108734	01214121406	63	21	27	27	85	36	10	M-5
2108735	01214122406	63	21	27	27	120	36	10	M-5
2108736	01214123406	63	21	27	27	160	36	10	M-5
2108737	01214121408	63	21	27	27	85	36	10	M-6
2108738	01214122408	63	21	27	27	120	36	10	M-6
2108739	01214123408	63	21	27	32	160	36	10	M-6
2108740	01214121410	63	24	32	32	85	42	10	M-8
2108741	01214122410	63	24	32	32	120	42	10	M-8
2108742	01214123410	63	24	32	32	160	42	10	M-8
2108743	01214121412	63	24	32	32	90	47	10	M-10
2108744	01214122412	63	24	32	32	120	47	10	M-10
2108745	01214123412	63	24	32	34	160	47	10	M-10
2108746	01214121414	63	27	34	34	90	47	10	M-10
2108747	01214122414	63	27	34	34	120	47	10	M-10
2108748	01214123414	63	27	34	34	160	47	10	M-10



Ref.	Código	D HSK-A	D ₁	D ₂	D ₃	L	L ₁	L ₂	G
2108749	01214121416	63	16	27	34	95	50	10	M-12
2108750	01214122416	63	16	27	34	120	50	10	M-12
2108751	01214123416	63	16	27	34	160	50	10	M-12
2108752	01214121418	63	18	33	42	95	50	10	M-12
2108753	01214121420	63	20	33	42	100	52	10	M-16
2108754	01214121435	63	25	44	53	115	58	10	M-20
2108755	01214121432	63	32	44	53	120	58	10	M-20
2108756	01214121506	80	6	21	27	85	36	10	M-5
2108757	01214121508	80	8	21	27	85	36	10	M-6
2108758	01214121510	80	10	24	32	90	42	10	M-8
2108759	01214121512	80	12	24	32	95	47	10	M-10
2108760	01214121514	80	14	27	34	95	47	10	M-10
2108761	01214121516	80	16	27	34	100	50	10	M-12
2108762	01214121518	80	18	33	42	100	50	10	M-12
2108763	01214121520	80	20	33	42	105	52	10	M-16
2108764	01214121525	80	25	44	53	115	58	10	M-20
2108765	01214121532	80	32	44	53	120	58	10	M-20
2108766	01214121606	100	6	21	27	85	36	10	M-5
2108767	01214121608	100	8	21	27	85	36	10	M-6
2108768	01214121610	100	10	24	32	90	42	10	M-8
2108769	01214121612	100	12	24	32	95	47	10	M-10
2108770	01214121614	100	14	27	34	95	47	10	M-10
2108771	01214121616	100	16	27	34	100	50	10	M-12
2108772	01214121618	100	18	33	42	100	50	10	M-12
2108773	01214121620	100	20	33	42	105	52	10	M-16
2108774	01214121625	100	25	44	53	115	58	10	M-20
2108775	01214121632	100	32	44	53	120	58	10	M-20

Ref.	Código	K DIN 69871	D ₁	D ₂	D ₃	L	L ₁	L ₂	G
2108818	01233121232	40	32	44	50	100	58	10	M-20
2108819	01233121406	50	6	21	27	80	36	10	M-5
2108820	01233121408	50	8	21	27	80	36	10	M-6
2108821	01233121410	50	10	24	32	80	42	10	M-8
2108822	01233121412	50	12	24	32	80	47	10	M-10
2108823	01233121414	50	14	27	34	80	47	10	M-10
2108824	01233121416	50	16	27	34	80	50	10	M-12
2108825	01233121418	50	18	33	42	80	50	10	M-12
2108826	01233121420	50	20	33	42	80	52	10	M-16
2108827	01233121425	50	25	44	53	100	58	10	M-20
2108828	01233121432	50	32	44	53	100	58	10	M-20

PORTAFRESAS DE AMARRE POR CONTRACCIÓN TÉRMICA SERIE MEDIA

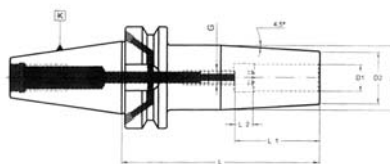

Desviación circular entre K y D₁ ≤ 0,003

PORTAFRESAS DIN 69871

PORTAFRESAS DE AMARRE POR CONTRACCIÓN TÉRMICA SERIE NORMAL

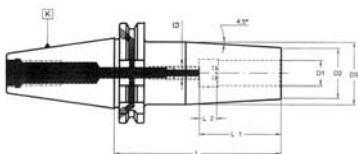

Desviación circular entre K y D₁ ≤ 0,003

Ref.	Código	K DIN 69871	D ₁	D ₂	D ₃	L	L ₁	L ₂	G
2108800	01233122203	40	3	12	20	120	20	5	M-5
2108801	01233122204	40	4	14	22	120	20	5	M-5
2108802	01233122205	40	5	16	22	120	25	5	M-5
2108803	01233121206	40	6	21	27	80	36	10	M-5
2108804	01233122206	40	6	21	27	120	36	10	M-5
2108805	01233121208	40	8	21	27	80	36	10	M-6
2108806	01233122208	40	8	21	27	120	36	10	M-6
2108807	01233121210	40	10	24	32	80	42	10	M-8
2108808	01233122210	40	10	24	32	120	42	10	M-8
2108809	01233121212	40	12	24	32	80	47	10	M-10
2108810	01233122212	40	12	24	32	120	47	10	M-10
2108811	01233121214	40	14	27	34	80	47	10	M-10
2108812	01233122214	40	14	27	34	120	47	10	M-10
2108813	01233121216	40	16	27	34	80	50	10	M-12
2108814	01233122216	40	16	27	34	120	50	10	M-12
2108815	01233121218	40	18	33	42	80	50	10	M-12
2108816	01233121220	40	20	33	42	80	52	10	M-16
2108817	01233121225	40	25	44	50	100	58	10	M-20

Ref.	Código	K DIN 69871	D ₁	D ₂	D ₃	L	L ₁	L ₂	G
2108900	01232122203	40	3	12	20	120	20	5	M-5
2108901	01232122204	40	4	14	22	120	20	5	M-5
2108902	01232122205	40	5	16	22	120	25	5	M-5
2108903	01232121206	40	6	21	27	90	36	10	M-5
2108904	01232122206	40	6	21	27	120	36	10	M-5
2108905	01232121208	40	8	21	27	90	36	10	M-6
2108906	01232122208	40	8	21	27	120	36	10	M-6
2108907	01232121210	40	10	24	32	90	42	10	M-8
2108908	01232122210	40	10	24	32	120	42	10	M-8
2108909	01232121212	40	12	24	32	90	47	10	M-10
2108910	01232122212	40	12	24	32	120	47	10	M-10
2108911	01232121214	40	14	27	34	90	47	10	M-10
2108912	01232122214	40	14	27	34	120	47	10	M-10
2108913	01232121216	40	16	27	34	90	50	10	M-12
2108914	01232122216	40	16	27	34	120	50	10	M-12
2108915	01232121218	40	18	33	42	90	50	10	M-12
2108916	01232121220	40	20	33	42	90	52	10	M-16
2108917	01232121225	40	25	44	53	110	58	10	M-20
2108918	01232121232	40	32	44	53	110	58	10	M-20
2108919	01232121406	50	6	21	27	100	25	10	M-5
2108920	01232121408	50	8	21	27	100	25	10	M-6
2108921	01232121410	50	10	24	32	100	42	10	M-8
2108922	01232121412	50	12	24	32	100	47	10	M-10
2108923	01232121414	50	14	27	34	100	47	10	M-10
2108924	01232121416	50	16	27	34	100	50	10	M-12
2108925	01232121418	50	18	33	42	100	50	10	M-12
2108926	01232121420	50	20	33	42	100	52	10	M-16
2108927	01232121435	50	25	44	53	120	58	10	M-20
2108928	01232121432	50	32	44	53	120	58	10	M-20